

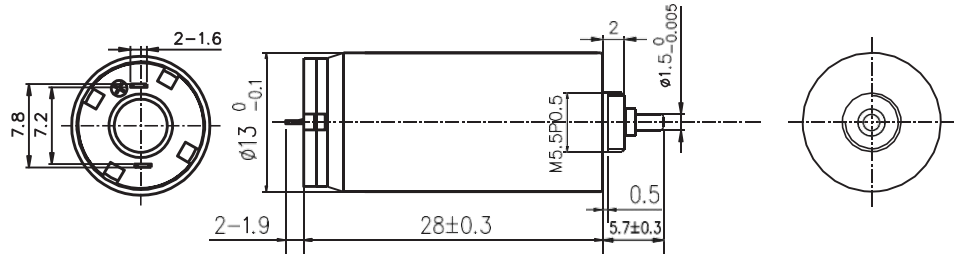

Mach Motion Products

CORELESS MOTORS



1328R

Motor Data	04A
Values at nominal voltage	
Nominal Voltage	4.5V
No Load Speed	8670rpm
No Load Current	16mA
Nominal Speed	10000rpm
Nominal Torque	3.5mNm
Nominal Current	0.73A
Stall Torque	6.8mNm
Stall Current	7.5A
Max Efficiency	80%
Motor Constant	
Terminal Resistance	0.40Ω
Torque Constant	4.9 mNm/A
Speed Constant	2533 rpm/V

Other Characteristic parameters	
Ambient Temperature	-10-40°C
Max permissible winding temp	80°C
Max permissible speed	25000rpm
Number of the pole pairs	1
Number of the commutator segments	5
Weight	20g